

REV.	CHANGE	DATE	DESIGNED	APPROVED
E	CONFIGURATIONS ADDED	27.10.2021	MAS	VPA

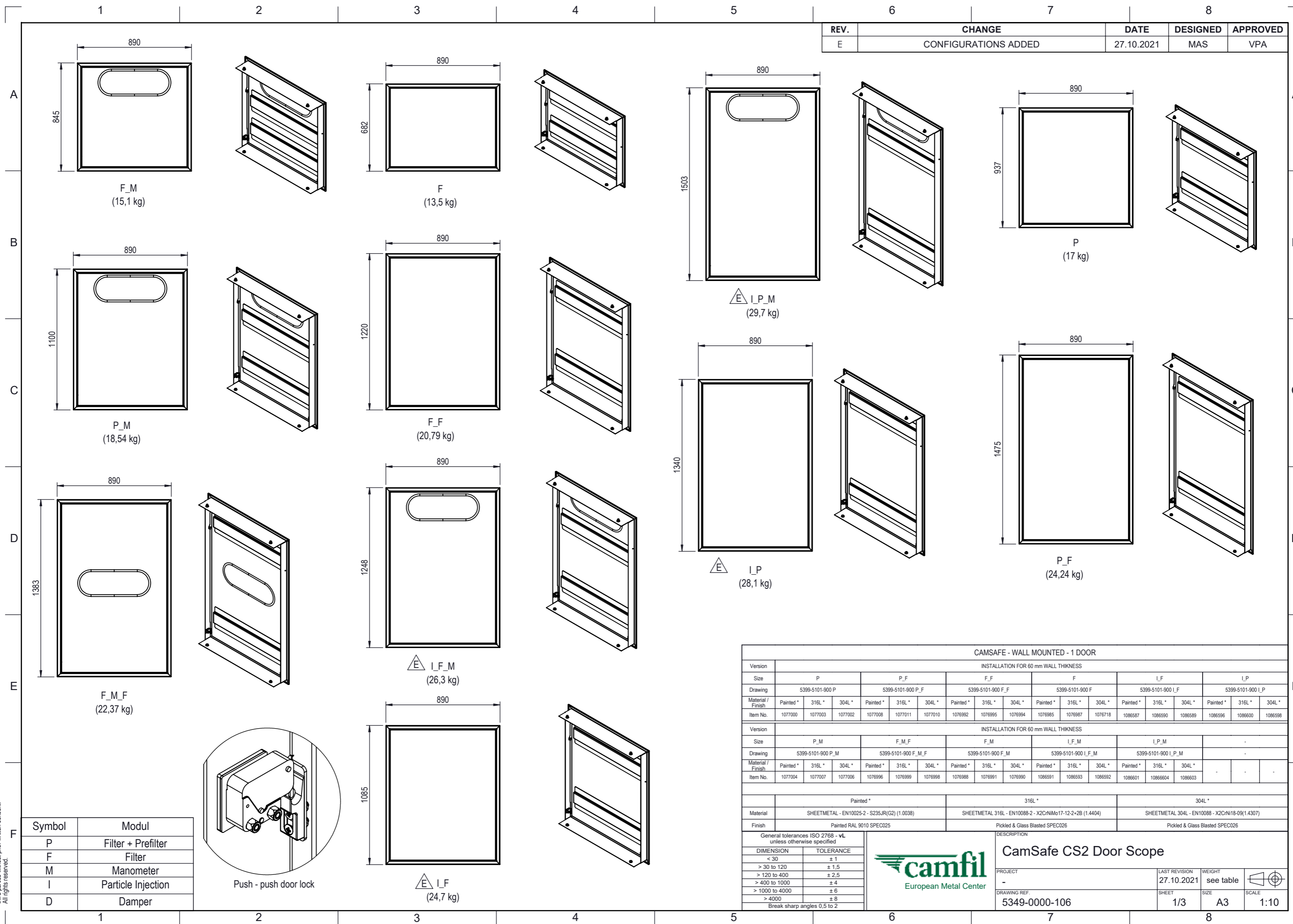

NB: The copyright of this drawing remains with Camfil. Contents must not be used, copied or disclosed to third parties without prior written consent. All rights reserved.

Symbol	Modul
P	Filter + Prefilter
F	Filter
M	Manometer
I	Particle Injection
D	Damper

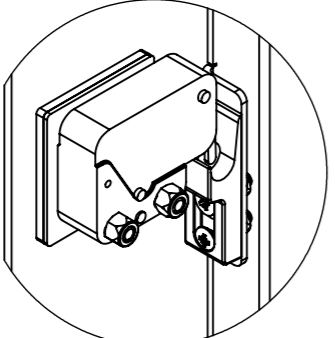

Push - push door lock

CAMSAFE - WALL MOUNTED - 1 DOOR																		
INSTALLATION FOR 60 mm WALL THICKNESS																		
Version	-																	
Size	P			P_F			F_F			F								
Drawing	5399-5101-900 P			5399-5101-900 P_F			5399-5101-900 F_F			5399-5101-900 F								
Drawing	5399-5101-900 P_M			5399-5101-900 F_M_F			5399-5101-900 F_M			5399-5101-900 I_F_M								
Drawing	5399-5101-900 I_P_M			-			-			-								
Material / Finish	Painted *	316L *	304L *	Painted *	316L *	304L *	Painted *	316L *	304L *	Painted *	316L *	304L *	Painted *	316L *	304L *	Painted *	316L *	304L *
Item No.	1077000	1077003	1077002	1077008	1077011	1077010	1076992	1076995	1076994	1076985	1076987	1076718	1086587	1086590	1086589	1086596	1086600	1086598
INSTALLATION FOR 60 mm WALL THICKNESS																		
Version	-																	
Size	P_M			F_M_F			F_M			I_F_M								
Drawing	5399-5101-900 P_M			5399-5101-900 F_M_F			5399-5101-900 F_M			5399-5101-900 I_F_M								
Drawing	5399-5101-900 I_P_M			-			-			-								
Material / Finish	Painted *	316L *	304L *	Painted *	316L *	304L *	Painted *	316L *	304L *	Painted *	316L *	304L *	Painted *	316L *	304L *	Painted *	316L *	304L *
Item No.	1077004	1077007	1077006	1076996	1076999	1076998	1076988	1076991	1076990	1086591	1086593	1086592	1086601	1086604	1086603			
Material	Painted RAL 9010 SPEC025						Painted *			316L *			304L *					
Material	SHEETMETAL - EN10025-2 - S235JR(G2) (1.0038)						SHEETMETAL 316L - EN10088-2 - X2CrNiMo17-12-2+2B (1.4404)			SHEETMETAL 304L - EN10088 - X2CrNi18-09(1.4307)								
Finish	Painted RAL 9010 SPEC025						Pickled & Glass Blasted SPEC026			Pickled & Glass Blasted SPEC026			Pickled & Glass Blasted SPEC026					
General tolerances ISO 2768 - vL unless otherwise specified																		
DIMENSION		TOLERANCE																
< 30		± 1																
> 30 to 120		± 1,5																
> 120 to 400		± 2,5																
> 400 to 1000		± 4																
> 1000 to 4000		± 6																
> 4000		± 8																
Break sharp angles 0,5 to 2																		
DESCRIPTION						CamSafe CS2 Door Scope												
PROJECT						LAST REVISION						WEIGHT		SCALE				
-						27.10.2021						see table		1:10				
DRAWING REF.						SHEET						SIZE		SCALE				
5349-0000-106						1/3						A3		1:10				



REV.	CHANGE	DATE	DESIGNED	APPROVED
E	CONFIGURATIONS ADDED	27.10.2021	MAS	VPA

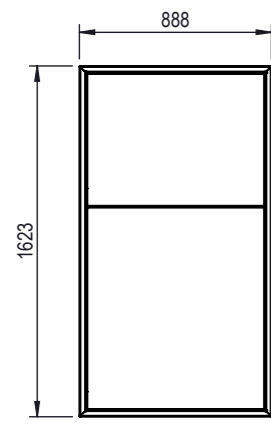

F_I_F
(26,47 kg)

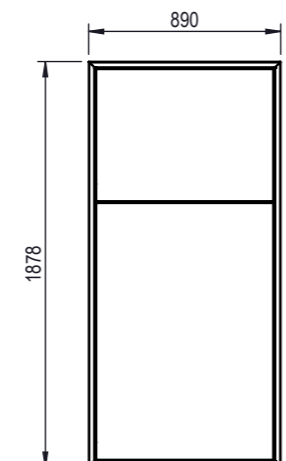
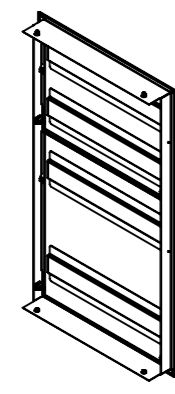

P_I_F
(29,92 kg)

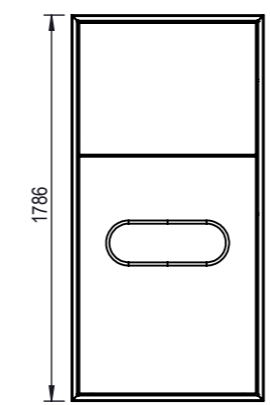
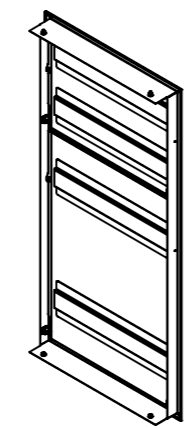

F_M_I_F
(28 kg)

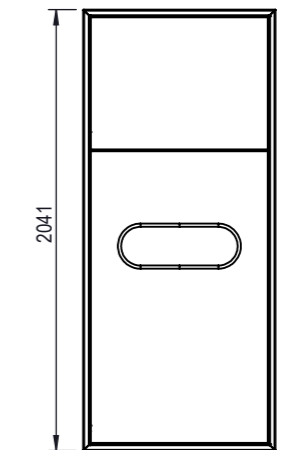
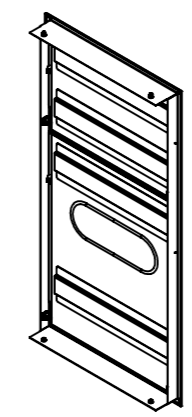

P_M_I_F
(31,50 kg)

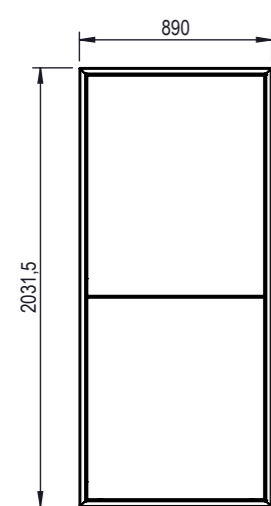
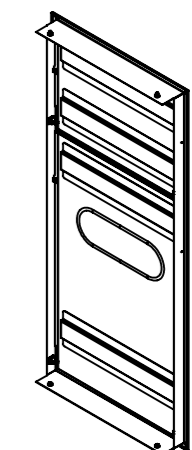

F_I_F-D
(31,32 kg)

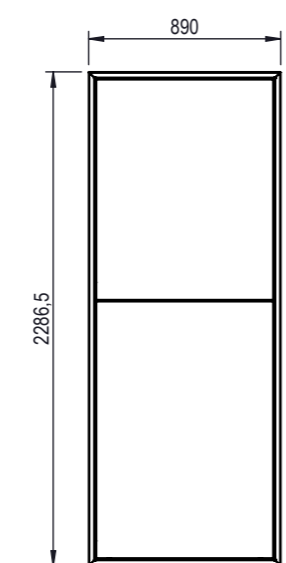
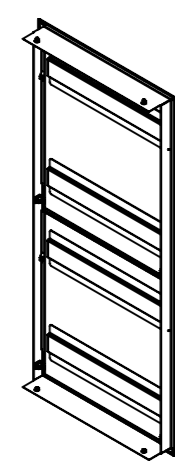

P_I_F-D
(34,77 kg)

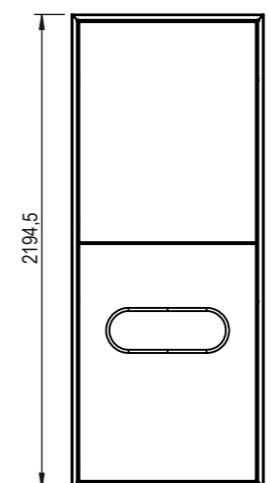
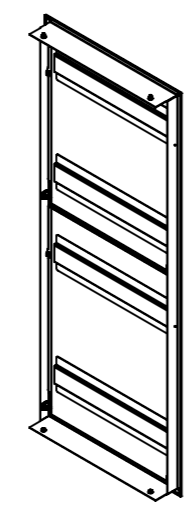

F_M_I_F-D
(32,9 kg)

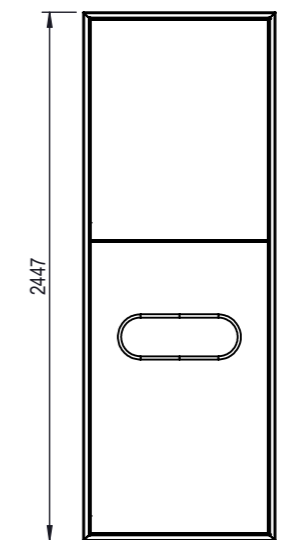
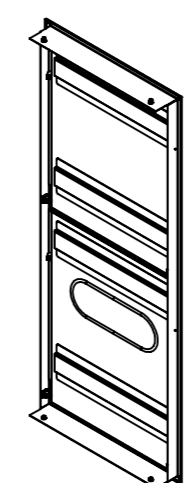

P_M_I_F-D
(36,35 kg)

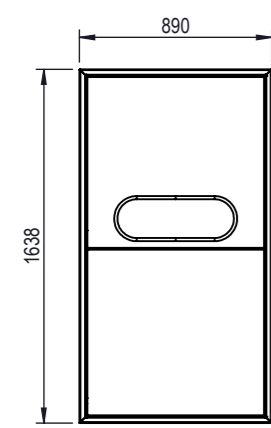
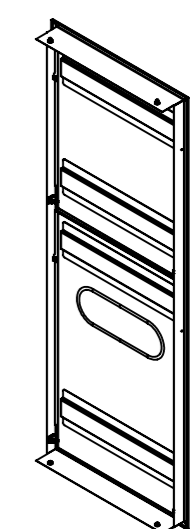

P_M_F
(26 kg)

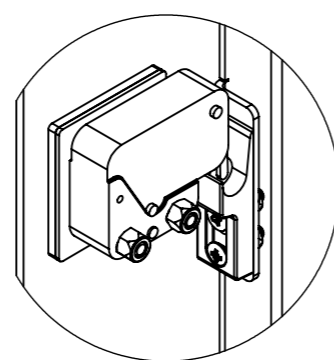
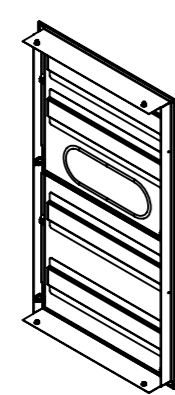

Push - push door lock

CAMSAFE - WALL MOUNTED - 2 DOORS															
INSTALLATION FOR 60 mm WALL THICKNESS															
Version	F_I_F			P_I_F			F_I_F-D			P_I_F-D			P_M_F		
Size	F_I_F			P_I_F			F_I_F-D			P_I_F-D			P_M_F		
Drawing	5399-5201-900 F_I_F			5399-5201-900 P_I_F			5399-5201-900 F_I_F-D			5399-5201-900 P_I_F-D			5399-5201-900 P_M_F		
Material / Finish	Painted *	316L *	304L *	Painted *	316L *	304L *	Painted *	316L *	304L *	Painted *	316L *	304L *	Painted *	316L *	304L *
Item No.	1076669	1077018	1077017	1077023	1077026	1077025	1077031	1077034	1077033	1077039	1077042	1077041	1076719	1077014	1077013
INSTALLATION FOR 60 mm WALL THICKNESS															
Version	F_M_I_F			F_M_I_F-D			P_M_I_F			P_M_I_F-D			-		
Size	F_M_I_F			F_M_I_F-D			P_M_I_F			P_M_I_F-D			-		
Drawing	5399-5201-900 F_M_I_F			5399-5201-900 F_M_I_F-D			5399-5201-900 P_M_I_F			5399-5201-900 P_M_I_F-D			-		
Material / Finish	Painted *	316L *	304L *	Painted *	316L *	304L *	Painted *	316L *	304L *	Painted *	316L *	304L *	-		
Item No.	1077019	1077022	1077021	1077035	1077038	1077037	1077027	1077030	1077029	1077043	1077046	1077045	-		
Material	Painted *						316L *			304L *					
Finish	SHEETMETAL - EN10025-2 - S235JR(G2) (1.0038)						SHEETMETAL 316L - EN10088-2 - X2CrNiMo17-12-2+2B (1.4404)			SHEETMETAL 304L - EN10088-2 - X2CrNi18-09 (1.4307)					
	Painted RAL 9010 SPEC025						Pickled & Glass Blasted SPEC026			Pickled & Glass Blasted SPEC026					

Symbol	Modul	General tolerances ISO 2768 - vL unless otherwise specified	
		DIMENSION	TOLERANCE
P	Filter + Prefilter	< 30	± 1
F	Filter	> 30 to 120	± 1,5
M	Manometer	> 120 to 400	± 2,5
I	Particle Injection	> 400 to 1000	± 4
		> 1000 to 4000	± 6
D	Damper	> 4000	± 8
		Break sharp angles 0,5 to 2	



DESCRIPTION			
CamSafe CS2 Door Scope			
PROJECT	LAST REVISION	WEIGHT	
-	27.10.2021	see table	
DRAWING REF.	SHEET	SIZE	SCALE
5349-0000-106	2/3	A3	1:10

NB: The copyright of this drawing remains with Camfil. Contents must not be used, copied or disclosed to third parties without prior written consent. All rights reserved.

1

2

3

4

5

6

7

8

REV.	CHANGE	DATE	DESIGNED	APPROVED
E	CONFIGURATIONS ADDED	27.10.2021	MAS	VPA

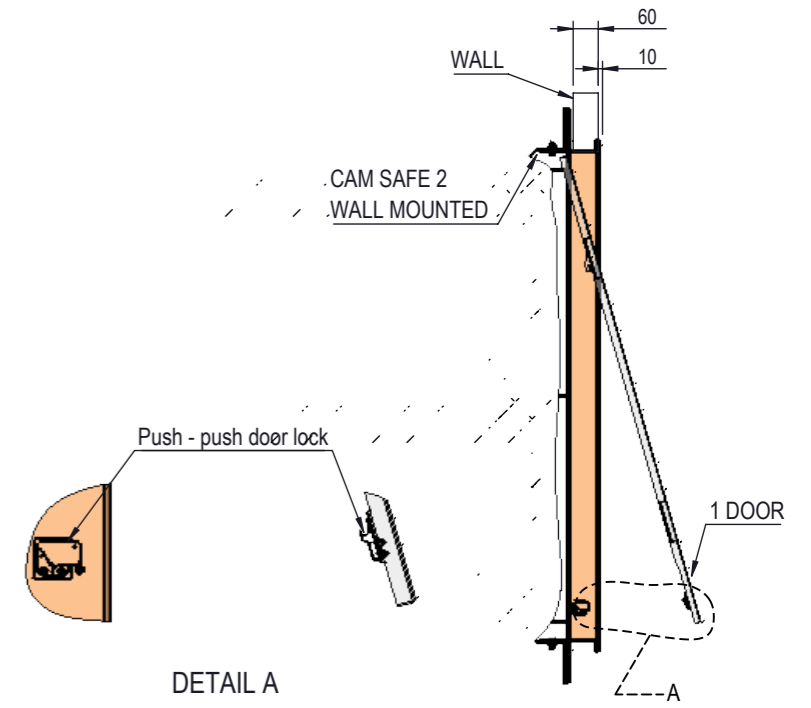
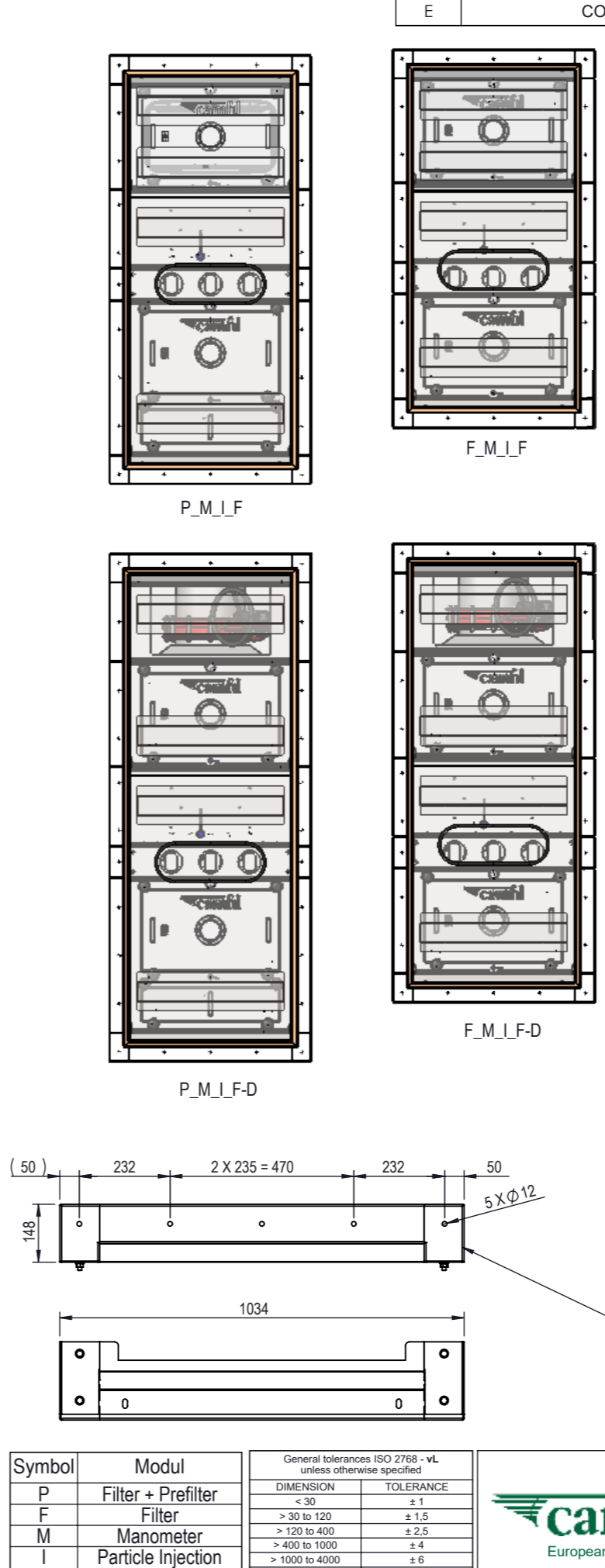
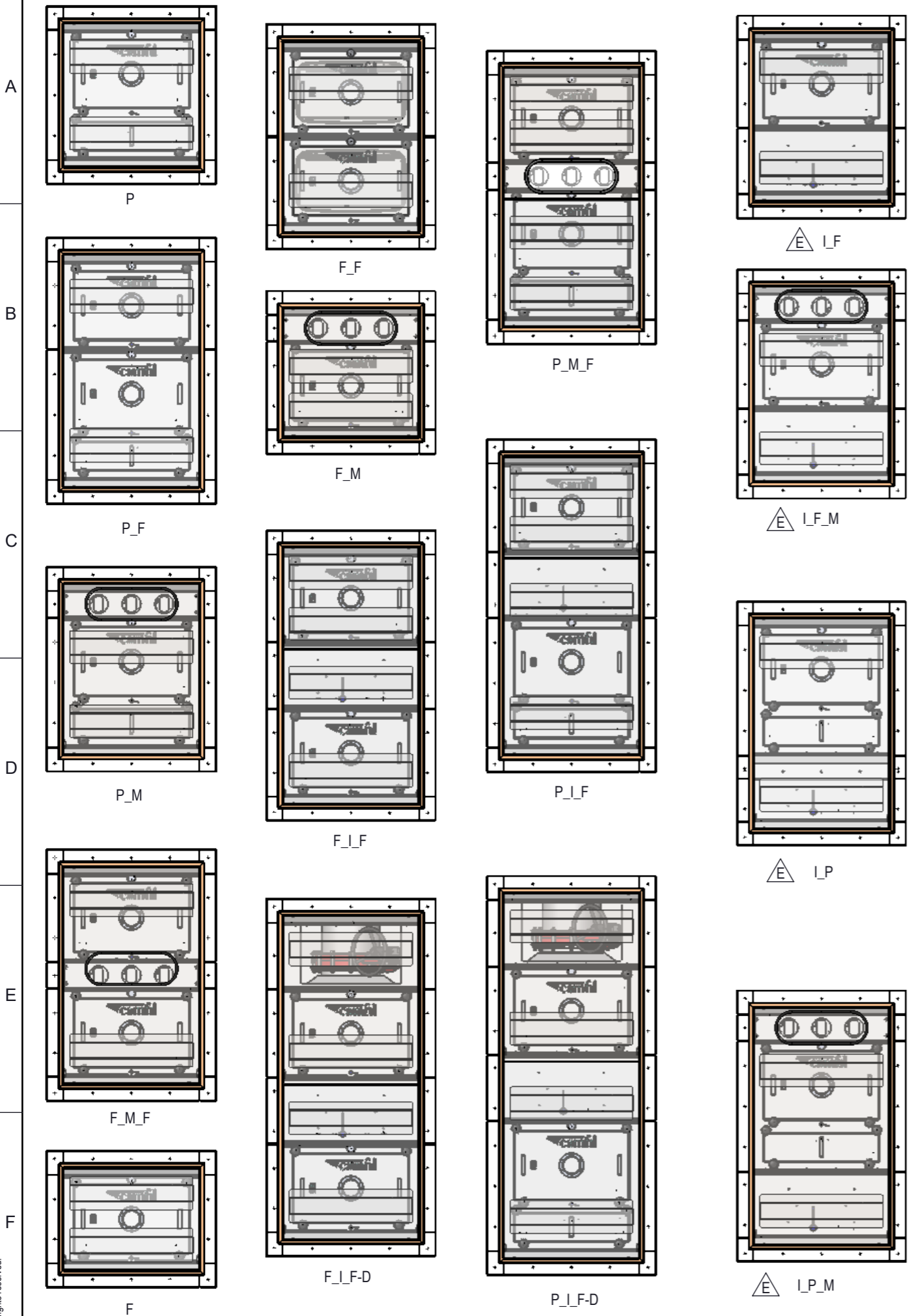

Standard door frames are designed for 60 mm thick wall panels. Other wall thicknesses available as custom versions upon request.

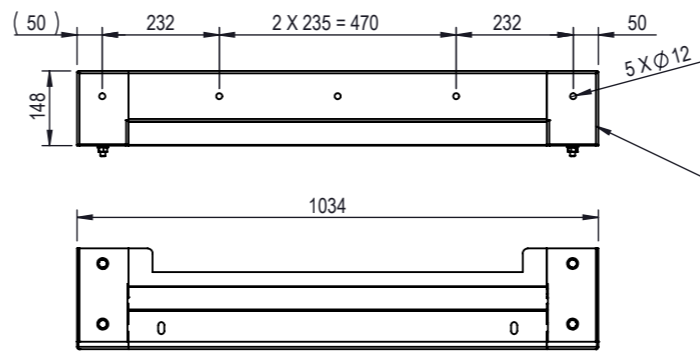
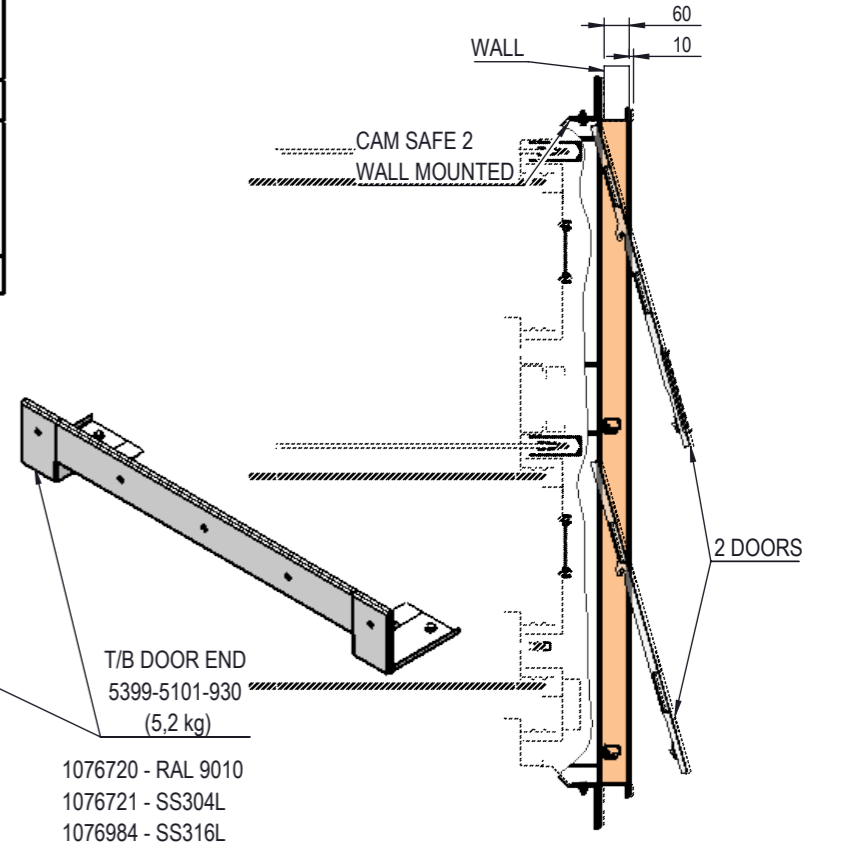

- 1076720 - RAL 9010
- 1076721 - SS304L
- 1076984 - SS316L

Symbol	Modul
P	Filter + Prefilter
F	Filter
M	Manometer
I	Particle Injection
D	Damper

General tolerances ISO 2768 - vL unless otherwise specified	
DIMENSION	TOLERANCE
< 30	± 1
> 30 to 120	± 1,5
> 120 to 400	± 2,5
> 400 to 1000	± 4
> 1000 to 4000	± 6
> 4000	± 8
Break sharp angles 0,5 to 2	



DESCRIPTION CamSafe CS2 Door Scope			
PROJECT	LAST REVISION	WEIGHT	
-	27.10.2021	-	
DRAWING REF.	SHEET	SIZE	SCALE
5349-0000-106	3/3	A3	1:10

NB: The copyright of this drawing remains with Camfil. Contents must not be used, copied or disclosed to third parties without prior written consent. All rights reserved.